

Asynchron-Pro types 8-pole

17/01/2024

Power

Continuous power for efficient water cooling

The peak power is considerably higher.

Speed	in krpm	0.5	1	1.5	2	2.5	3	3.5	4	4.5	5	6	8	10	12	15
Frequency	in Hz	34	67	100	134	167	200	234	267	300	334	400	534	667	800	1000
Types (D1/LFe in cm)		Power in kW														
mW 16/8-8-s1r..	2.2	4.3	6.5	8.6	10.8	12.9	14.4	15.7	15.8	15.8	14.5	11.9				
mW 16/10-8-s1r..	2.8	5.7	8.5	11.3	14.2	17	18.8	20	20	20						
mW 16/12.5-8-s1r..	3.6	7.2	10.7	14.3	17.9	21	25	28	28	28	25	21				
mW 16/17-8-s1r..	4.9	9.9	14.8	19.7	25	30	33	36	36	36	33	27				
mW 16/20-8-s1r..	6	11.9	17.9	24	30	36	40	43	44	44	40	33				
mW 16/22-8-s1r..	6.6	13.1	19.7	26	33	39	44	48	48	48	44	36				
mW 16/27-8-s1r..	8.2	16.5	25	33	41	49	55	60	60	60	55	45				
mW 18/8-8-s1r..	2.8	5.5	8.3	11	13.8	16.5	18.3	19.8	20	20	20					
mW 18/12-8-s1r..	4.2	8.4	12.6	16.8	21	25	28	31	31	31	31					
mW 18/18-8-s1r..	6.4	12.8	19.2	26	32	38	43	48	48	48	48	45				
mW 18/24-8-s1r..	9	18	27	36	45	54	60	66	67	67	67					
mW 18/33-8-s1r..	12.5	25	37	50	62	75	84	92	93	93						
mW 18/38-8-s1r..	14.4	29	43	58	72	86	97									
mW 20/16-8-s1r..	7.7	15.4	23	31	34	38	38	38	38	38	38	37	36	35	33	
mW 20/22-8-s1r..	10.7	21	32	43	48	53	53	53	53	53	52	49	47	44	40	
mW 20/26-8-s1r..	12.9	26	39	52	57	63	63	63	63	63	62	59	57	54	50	
mW 20/30-8-s1r..	15.3	31	46	61	68	74	75	75	75	75	75	73	70	68		
mW 20/39-8-s1r..	20	40	60	80	89	97	98	98	96	95	92					
mW 30/13-8-s2r..	16.4	33	49	66	66	66	66	66	66	66	66	66	66			
mW 30/16-8-s2r..	21	42	63	63	63	63	63	63	63	63	63	63	63			
mW 30/26.5-8-s2r..	37	74	74	74	74	74	74	74	74	74	74	74	74			
mW 30/35-8-s2r..	52	104	105	105	105	105	105	105	105	105	105	105	105			
mW 30/41-8-s2r..	60	119	120	120	120	120	120	120	120	120	120	120	120			
mW 30/48-8-s2r..	72	144	145	145	145	145	145	145	145	145	145	145	145			

Dimension sheet

Sketch

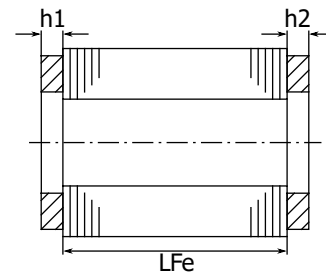
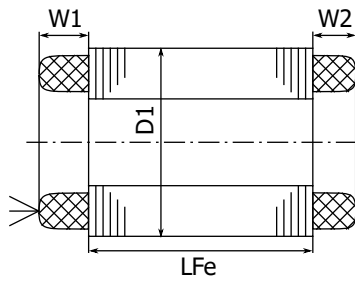

Main dimensions all dimensions in mm	Stator			Rotor						
	Outer diameter D1	Length of winding head		Bore				Ring length		
		W1	W2	d3 min		d3 max		h		
	Typ (D1/LFe in cm)	with PTC		Al	Cu	Al	Cu	Al	Cu	CuSt
mW 16/ .. -8-s1r..	160	43	30	-	74	-	80	-	6	-
mW 18/ .. -8-s1r..	180	40	30	-	87	-	90	-	6	-
mW 20/ .. -8-s1r..	200	46	33	-	98	-	100	-	5	14
mW 30/ .. -8-s2r..	300	49	40	-	147.5	-	153	-	5	11